



OPERATION INSTRUCTION

Digital Depth Gage With Round Depth Bar

Resolution: 0.01mm/0.0005"

Accuracy: $\pm 0.02\text{mm}/0.0008\text{"}$ (Range: 0-100mm/0-4")

$\pm 0.03\text{mm}/0.0012\text{"}$ (Range: 100-200mm/4-8")

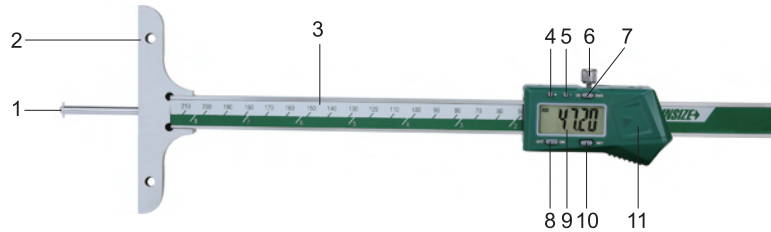

1-Point(Supplied with three interchangeable points)

2-Base plane

3-Beam

4-'+' button

5-'-' button

6-Locking screw

7-'in/mm' button

8-'OFF/ON' button

9-LCD display

10-'SET' button

11-Battery cover

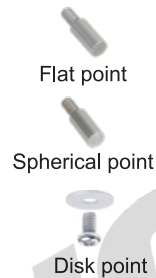

1. The product can measure depth of small holes($>\varnothing 4\text{mm}$), use disk point to measure the groove.

2. Install battery:

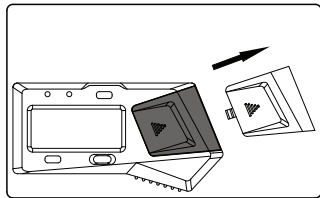

Step 1:
Remove the battery cover

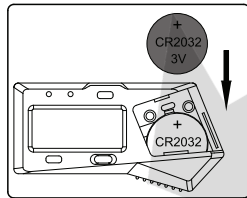

Step 2:
Put CR2032 into battery house, the positive side of battery (+) should face out

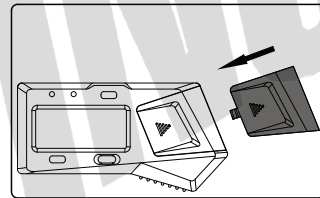

Step 3:
Close the battery cover

3. Buttons:

'in/mm' --- inch and mm conversion

'OFF/ON' --- turn off/on

'SET', '+', '-'

--- long press 'SET' >3s to preset initial reading, 'set' flickers on the screen, press '+' or '-' button to change the value, short press 'SET' to exit.

--- short press 'SET' to show the preset value

4. According to the workpiece's shape, install the point firmly. The measuring method is as following:

---Install flat point or spherical point: put base plane on plate, gently pull the beam to let point contact with the plate and press '0' button to set zero. Measure the depth A(Fig.2).

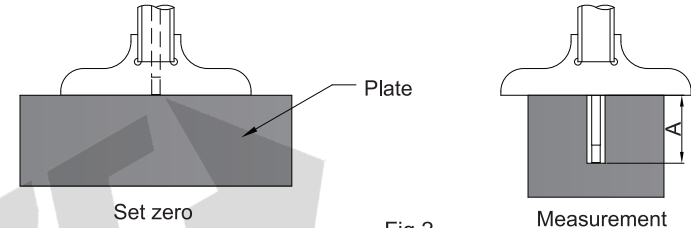

Fig.2

---Install disk point: pull beam to make the point's measuring face contact base plane and press '0' button to set zero. Measure depth A1 and A2 (Fig.3). The disk point's thickness is 1mm, the A2 result is the reading plus 1mm.

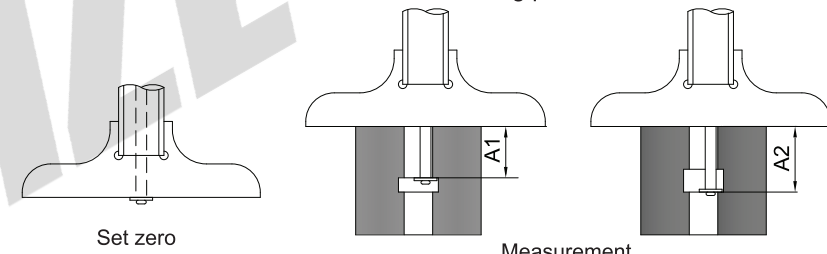

Fig.3

Notice: Set zero again after replacing the point

Make sure there are no dust, cutting chips or other debris on the measuring faces and workpiece surface, otherwise, the measurement may be incorrect.

Measuring face and base plane should be protected from being scratched or damaged. It is necessary to press the base steady and apply constant and proper force to pull the beam.

5. One battery can last for one year use. When the battery is running out, display will become weak, abnormal reading or other phenomena will appear when moving the digital unit, please replace battery. If caliper is not be used for more than 3 months, please remove the battery. Otherwise, liquid may leak from the battery and damage the caliper.

6. If digits do not change when buttons are pressed, take out battery and put it back after 1 minute.

7. Working temperature is 0-40°C/32-104°F, relative humidity should not exceed 80%.

MN-1148-C/E

V3